

CONSTRUCTION PLANS
for
DILLSBORO PARK
BASKETBALL & PICKLEBALL
COURTS

9495 ARLINGTON ROAD
DILLSBORO, IN 47018

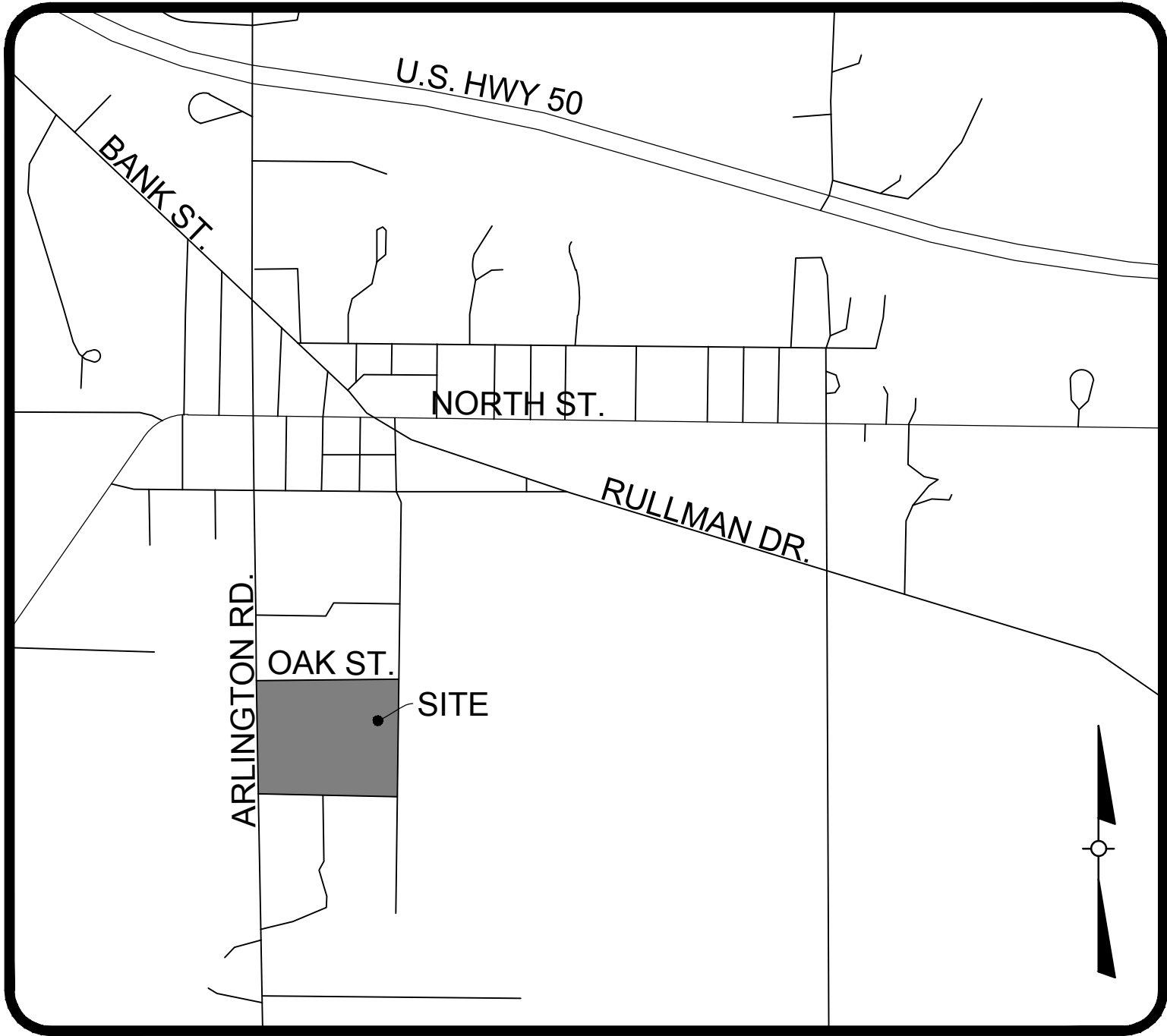

LOCATION MAP
NOT TO SCALE

UTILITY CONTACTS:

WATER:	DILLSBORO WATER DISTRICT CONTACT: MATT BAUER (812) 432-3243
ELECTRIC:	DUKE ENERGY CONTACT: (800) 774-0246
CABLE:	COMCAST CONTACT: (844) 350-2469
GAS:	SOUTHERN INDIANA NATURAL GAS CONTACT: (812) 654 2444
STORM:	TOWN OF DILLSBORO CONTACT: MATT BAUER (812) 432-3243
SANITARY:	TOWN OF DILLSBORO CONTACT: MATT BAUER (812) 432-3243

AREA OF DISTURBANCE

40,570 S.F. (±0.93 AC)

ABBREVIATIONS

PROPOSED	PR.
EXISTING	EX.
DO NOT DISTURB	DND
TO BE REMOVED	TBR
FINISHED FLOOR ELEVATION	F.F.E.
TOP OF GRATE	TG
TOP OF LID	T/L
INVERT ELEVATION	I.E.
PROPERTY SERVICE CONNECTION	PSC
MANHOLE	MH
STORM MANHOLE	STRMH
SANITARY MANHOLE	SANMH
JUNCTION BOX	JB
CATCH BASIN	CB
TEMPORARY BENCHMARK	TBM
RIGHT OF WAY	R/W
PROPERTY LINE	PL
BUILDING	BLDG.
LANDSCAPE BUFFER AREA	L.B.A.
PROPOSED PARKING COUNTS	# SPACES
EXISTING PARKING COUNTS	# Ex. Spoces
TOP OF CURB	TOC
BASE OF CURB	BOC

PR. EDGE OF PAVEMENT	PR. HYDRANT
PR. CURB	PR. WATER VALVE
PR. SHOULDER	PR. IRRIGATION VALVE
PR. STRIPING	PR. WATER SHUTOFF
PR. PROPERTY LINE	PR. WATER METER
PR. SITE PROPERTY LINE	PR. MONITORING WELL
PR. RIGHT OF WAY	PR. WELL
PR. EASEMENT	PR. SANITARY SEWER
PR. FENCE	PR. 4" PSC
PR. WATER LINE	PR. 6" PSC
PR. PROPERTY SERVICE CONNECTION	PR. CLEAN OUT
PR. SWALE	PR. STORM MANHOLE
PR. GAS LINE	PR. CATCH BASIN TYPE 1
PR. OVERHEAD ELECTRIC LINE	PR. CATCH BASIN TYPE 2
PR. UNDERGROUND TELEPHONE LINE	PR. DOWN SPOUT
PR. FIBER OPTIC LINE	PR. TELEPHONE MANHOLE
PR. CABLE LINE	PR. TELEPHONE PEDESTAL
PR. LANDSCAPE BUFFER LINE	PR. ELECTRIC MANHOLE
PR. TREE LINE	PR. TRANSFORMER
PR. MAJOR & MINOR CONTOURS	PR. ELECTRIC METER
PR. SANITARY SEWER	PR. LIGHT POLE
PR. STORM SEWER	PR. POWER POLE
PR. RIP RAP	PR. GUYWIRE
PR. BUILDING	PR. GAS VALVE
PR. CONCRETE	PR. GAS METER
PR. TRACKS	PR. DRILL HOLE
PR. BUILDING SETBACK LINE	PR. TEST PIT
PR. 25' BUFFER AREA FOR BLUE LINE STREAM	PR. SIGN
PR. FORM DISTRICT TRANSITION ZONE (FDTZ)	PR. MAILBOX
PR. SPOT ELEVATION	PR. BOLLARD
	PR. SHRUB
	PR. TREE
	PR. TREE TO BE REMOVED
	PR. HYDRANT
	PR. WATER VALVE
	PR. IRRIGATION VALVE
	PR. WATER SHUTOFF
	PR. WATER METER
	PR. MONITORING WELL
	PR. WELL
	PR. SANITARY SEWER
	PR. 4" PSC
	PR. 6" PSC
	PR. CLEAN OUT
	PR. STORM MANHOLE
	PR. CATCH BASIN TYPE 1
	PR. CATCH BASIN TYPE 2
	PR. DOWN SPOUT
	PR. TELEPHONE MANHOLE
	PR. TELEPHONE PEDESTAL
	PR. TEST PIT
	PR. ELECTRIC MANHOLE
	PR. TRANSFORMER
	PR. ELECTRIC METER
	PR. LIGHT POLE
	PR. POWER POLE
	PR. GUYWIRE
	PR. SIGN
	PR. GAS VALVE
	PR. GAS METER
	PR. DRILL HOLE
	PR. MAILBOX
	PR. BOLLARD
	TEMPORARY BENCHMARK
	PR. SHRUB
	PR. TREE

GENERAL NOTES:

- ALL AREAS DISTURBED BY THE CONTRACTOR'S ACTIVITIES SHALL BE SEEDED, STRAWED/MULCHED & PROTECTED FROM EROSION PER THE SPECIFICATIONS.
- CONTRACTOR TO COORDINATE ANY NEEDED UTILITY RELOCATIONS WITH APPROPRIATE UTILITY COMPANY. COSTS ASSOCIATED WITH ANY NECESSARY UTILITY RELOCATIONS SHALL BE AT THE OWNER'S OR UTILITY COMPANIES EXPENSE, PROVIDED THAT THE COSTS ARE AGREED UPON PRIOR TO COMMENCING THE WORK.
- SHOP DRAWINGS SHALL BE SUBMITTED FOR ALL MATERIALS USED TO COMPLETE THE PROJECT.
- CONTRACTOR TO USE INDOT #8 STONE BACKFILL UNDER ALL STRUCTURES PLACED ON DISTURBED EARTH UNLESS OTHERWISE INDICATED ON THE PLANS.
- ALL EX. STRUCTURES, PIPES, UTILITIES, ETC. DISTURBED DURING CONSTRUCTION SHALL BE REPLACED IN KIND UNLESS OTHERWISE NOTED.
- BACKFILL TYPE 1-GRANULAR BACKFILL MATERIAL SHALL BE INDOT #8 IN ACCORDANCE WITH INDOT STANDARD SPECS. GRANULAR BACKFILL LIMITS SHALL INCLUDE ALL WORK WITHIN PAVED AREAS & ALL WORK WITHIN 5' OF PAVED AREAS (UNLESS SHOWN OTHERWISE ON THE PLANS).
- BACKFILL TYPE 2-IN AREAS NOT REQUIRING GRANULAR BACKFILL MATERIAL, THE TRENCH SHALL BE CAREFULLY BACKFILLED WITH CLEAN EARTH FILL MATERIAL FREE OF ROCKS LARGER THAN 2", FROZEN LUMPS OF SOIL, WOOD OR OTHER EXTRANEOUS MATERIAL.

EPSC NOTES

- THE APPROVED EROSION PREVENTION AND SEDIMENT CONTROL (EPSC) PLAN SHALL BE IMPLEMENTED PRIOR TO ANY LAND DISTURBING ACTIVITY ON THE CONSTRUCTION SITE. ANY MODIFICATIONS TO THE APPROVED EPSC PLAN MUST BE REVIEWED AND APPROVED BY THE LOCAL REVIEWING AUTHORITY.
- DETENTION BASINS, IF APPLICABLE, SHALL BE CONSTRUCTED FIRST AND SHALL PERFORM AS SEDIMENT BASINS DURING CONSTRUCTION UNTIL THE CONTRIBUTING AREAS ARE SEEDED AND STABILIZED.
- ACTIONS MUST BE TAKEN TO MINIMIZE THE TRACKING OF MUD AND SOIL FROM CONSTRUCTION AREAS ONTO PUBLIC ROADWAYS. ALL TRUCKS & EQUIPMENT WILL HAVE THE DIRT REMOVED FROM TIRES BEFORE ENTERING A PUBLIC ROADWAY. A WASH AREA WILL BE SET UP. THIS AREA WILL BE PROTECTED WITH SEDIMENT CONTROLS. SOIL TRACKED ONTO THE ROADWAYS SHALL BE REMOVED DAILY.
- SOIL STOCKPILES SHALL BE LOCATED AWAY FROM STREAMS, PONDS, SWALES AND CATCH BASINS. STOCKPILES SHALL BE SEEDED, MULCHED, AND ADEQUATELY CONTAINED THROUGH THE USE OF SILT FENCE.
- SEDIMENT-LADEN GROUNDWATER ENCOUNTERED DURING TRENCHING, BORING OR OTHER EXCAVATION ACTIVITIES SHALL BE PUMPED TO A SEDIMENT TRAPPING DEVICE PRIOR TO BEING DISCHARGED INTO A STREAM, POND, OR CATCH BASIN.
- WHERE CONSTRUCTION OR LAND DISTURBANCE ACTIVITY WILL OR HAS TEMPORARILY CEASED ON ANY PORTION OF A SITE, TEMPORARY SITE STABILIZATION MEASURES SHALL BE REQUIRED AS SOON AS PRACTICAL, BUT NO LATER THAN 14 CALENDAR DAYS AFTER THE ACTIVITY HAS CEASED.
- THE EROSION PREVENTION AND SEDIMENT CONTROL DEVICES SHOWN ON THIS PLAN SET ARE INTENDED TO BE THE MINIMUM CONTROL MEASURES. ADDITIONAL EPSC DEVICES MAY NEED TO BE INSTALLED AS NECESSARY BY THE CONTRACTOR TO PREVENT EROSION AND SEDIMENTATION.
- AT THE END OF EACH WORK DAY, THE SITE SHALL BE CLEANED OF SEDIMENT AND DEBRIS. DISTURBED AREAS SHALL HAVE SILT CONTROL INSTALLED OR WILL BE STABILIZED SO THAT SEDIMENT WILL NOT GET OFFSITE OR IN THE STORM SYSTEM DURING A RAIN EVENT.
- CONTRACTOR MUST MAINTAIN EPSC AT ALL TIMES.
- PORTABLE SANITARY FACILITIES AND FUEL TANKS ARE NOT SHOWN ON THIS PLAN. CONTRACTOR TO COORDINATE LOCATION(S) WITH OWNER AT PRE-CONSTRUCTION MEETING AND ADD LOCATIONS ON PLAN. PLAN MUST BE UPDATED AT ALL TIMES TO REFLECT CURRENT SITE CONDITIONS.
- CONCRETE WASHOUT AREA IS NOT SHOWN ON THIS PLAN. CONTRACTOR TO COORDINATE LOCATION(S) WITH OWNER AT PRE-CONSTRUCTION MEETING AND ADD LOCATIONS ON PLAN. CONTRACTOR SHALL MAINTAIN CONCRETE WASHOUT AREA.

THE CONTRACTOR ASSUMES SOLE RESPONSIBILITY
FOR SITE SAFETY

- IT SHALL BE THE RESPONSIBILITY OF ANY AND ALL CONTRACTORS INVOLVED IN THIS PROJECT TO DO WHATEVER IS NECESSARY TO COMPLY FULLY WITH THE " WILLIAMS - STEIGER OCCUPATIONAL SAFETY AND HEALTH ACT OF 1970".

BOUNDARY NOTE

BOUNDARY SHOWN HEREON WAS DERIVED FROM GIS DATA AND DOES NOT CONSTITUTE A SURVEY. FOR CONSTRUCTION PURPOSES, OWNER/CONTRACTOR SHOULD VERIFY TRUE BOUNDARY LIMITS OF ALL PROPERTIES AS NEEDED.

UTILITY NOTE:

ALL UTILITIES SHOWN ON THESE PLANS ARE APPROXIMATE. INDIVIDUAL SERVICE LINES ARE NOT SHOWN. PRIOR TO ANY EXCAVATION, IT SHALL BE THE RESPONSIBILITY OF THE CONTRACTOR TO CONTACT THE NECESSARY UTILITY AGENCIES AND OBTAIN THE PRECISE LOCATION OF THEIR FACILITIES. THE CONTRACTOR SHALL FAMILIARIZE THEMSELVES WITH ALL UTILITY REQUIREMENTS AS SET OUT ON THE PLANS, IN THE SPECIFICATIONS, AND IN THE SPECIAL PROVISIONS.

THE CONTRACTOR OR SUBCONTRACTOR SHALL NOTIFY THE UTILITY PROTECTION CENTER "HOLEY MOLEY" (TOLL FREE PHONE No. 1-800-382-5544) TWO (2) WORKING DAYS IN ADVANCE OF ANY CONSTRUCTION ON THIS PROJECT. THIS NUMBER WAS ESTABLISHED TO PROVIDE ACCURATE LOCATIONS OF EXISTING BELOW GROUND UTILITIES (I.E. CABLES, ELECTRIC WIRES, GAS & WATER LINES).



Revision	Date	Description	Detailed By	Chk'd By	Approved By

ENGINEER:
HERITAGE ENGINEERING, LLC
642 South 4th Street
Suite 100
Louisville, KY 40202
(502) 562-1412
(502) 562-1413 Fax

OWNER/DEVELOPER:
TOWN OF DILLSBORO
13080 EXECUTIVE DRIVE
P.O. BOX 127
DILLSBORO, IN 47018
(812) 432-3243

PROJECT:
CONSTRUCTION PLANS
FOR
DILLSBORO PARK BASKETBALL & PICKLEBALL COURTS
9495 ARLINGTON ROAD
DILLSBORO, IN
COVER

PROFESSIONAL SEAL
ROBERT LEE WOOD
REGISTERED
NO. 19800124
STATE OF INDIANA
DATE: 6/17/25

JOB NO: 25017
HORIZ. SCALE: N/A
VERTICAL SCALE: N/A
DESIGNED BY: CGH
DETAILED BY: ELM
CHECKED BY: -
DATE: 6/17/25

SHEET
C0.0

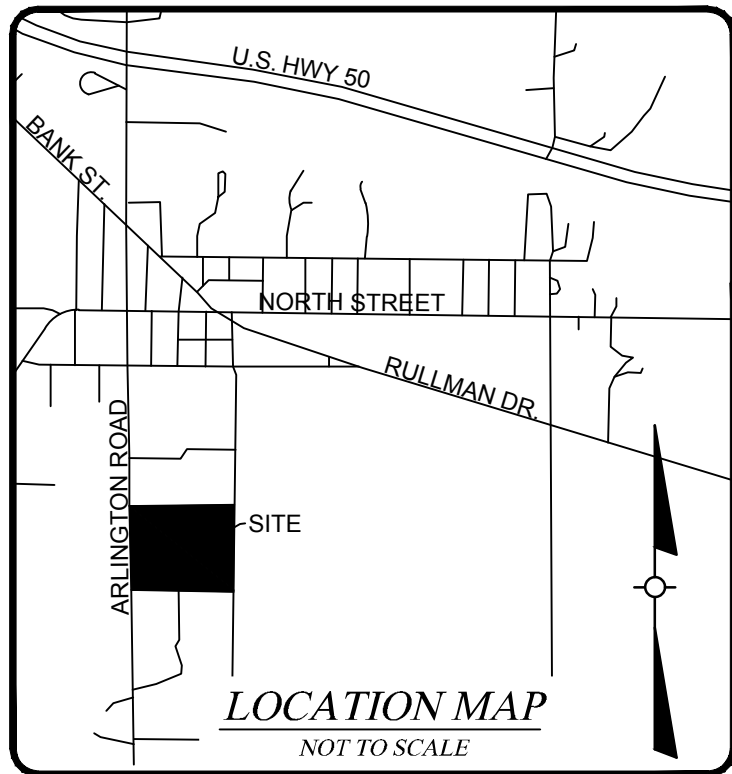
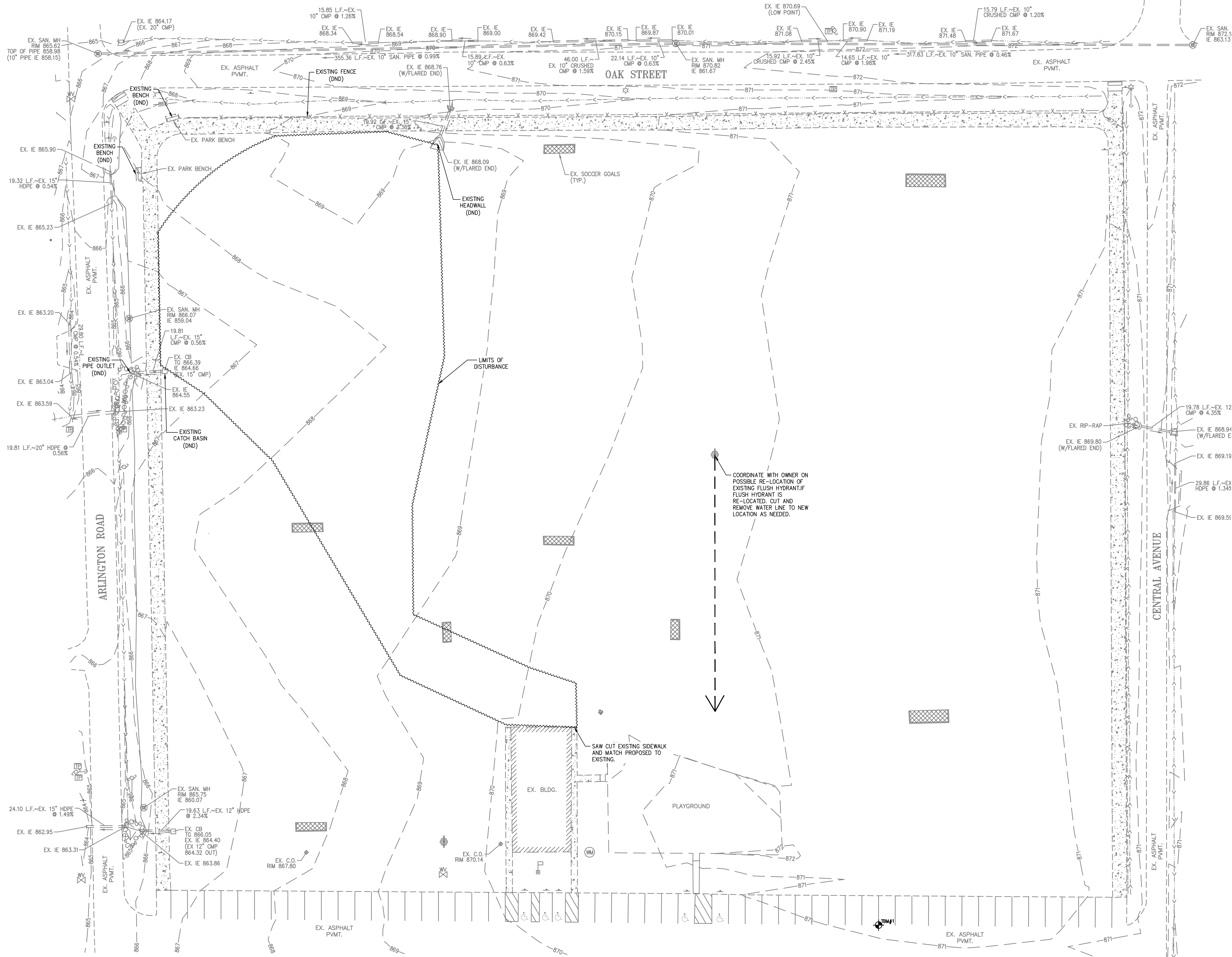

DEMOLITION NOTES

- ABANDON, REMOVE OR RELOCATE EX. UTILITIES, WHICH WILL INTERFERE WITH THE NEW CONSTRUCTION. COORDINATE WITH UTILITY COMPANIES.
- REMOVE ALL OTHER OBSTRUCTIONS AS REQUIRED WITHIN THE DEVELOPED AREA.
- CONTRACTOR TO COORDINATE ALL UTILITY REMOVAL AND ABANDONMENT WITH UTILITY COMPANIES.
- THE CONTRACTOR IS TO VERIFY THE EXACT LOCATION OF ALL EXISTING UTILITIES. TAKE CARE TO PROTECT UTILITIES THAT ARE TO REMAIN. REPAIR ANY DAMAGE ACCORDING TO LOCAL STANDARDS AND AT THE CONTRACTOR'S EXPENSE. COORDINATE ALL CONSTRUCTION WITH THE APPROPRIATE UTILITY COMPANY.
- THE CONTRACTOR SHALL CONFORM TO ALL LOCAL CODES AND RECEIVE APPROVAL WHERE NECESSARY BEFORE CONSTRUCTION.
- THE CONTRACTOR IS TO PROVIDE THE NECESSARY PROTECTION, IN ACCORDANCE WITH THE SPECIFICATIONS FOR TREES TO REMAIN. DO NOT OPERATE OR STORE HEAVY EQUIPMENT, NOR HANDLE OR STORE MATERIALS, WITHIN THE DRIPLINES OF TREES OUTSIDE THE LIMITS OF GRADING OR WITHIN THE DRIPLINES OF TREES TO REMAIN.
- CONSTRUCTION FENCING SHALL BE ERECTED AT THE EDGE OF THE AREA OF DEVELOPMENT PRIOR TO ANY GRADING OR CONSTRUCTION TO PROTECT THE EXISTING TREE STANDS AND THEIR ROOT SYSTEMS FROM COMPACTION. THE FENCING SHALL ENCLOSE THE ENTIRE AREA BENEATH THE TREE CANOPY AND SHALL REMAIN IN PLACE UNTIL ALL CONSTRUCTION IS COMPLETED. NO PARKING, MATERIAL STORAGE, OR CONSTRUCTION ACTIVITIES ARE PERMITTED WITHIN THE PROTECTED AREA.
- IT SHALL BE THE RESPONSIBILITY OF THE OWNER TO PERFORM ALL ENVIRONMENTAL SITE ASSESSMENTS AND PROPERLY REMOVE AND DISPOSE OF ANY HAZARDOUS MATERIALS ENCOUNTERED WITHIN EXISTING STRUCTURES. THESE MATERIALS INCLUDE, BUT ARE NOT LIMITED TO, ASBESTOS. ALL FEDERAL, STATE AND LOCAL ABATEMENT REGULATIONS SHALL BE FOLLOWED.
- ALL EPSC MEASURES SHALL BE INSTALLED PRIOR TO DEMOLITION OF ANY KIND.
- SHOULD THE CONTRACTOR DAMAGE EXISTING CONDITIONS OUTSIDE OF THE LIMITS OF DISTURBANCE BOUNDARIES THE COST FOR ALL REPAIRS SHALL BE BORNE BY THE CONTRACTOR.
- EXISTING ADJACENT BUSINESSES MUST REMAIN OPEN AND ACCESSIBLE DURING ALL PHASES OF CONSTRUCTION.
- CONTRACTOR IS RESPONSIBLE FOR MAINTAINING STORM WATER FLOW THROUGH SITE AT ALL TIMES.
- CONTRACTOR SHALL VERIFY EXISTING TREE SIZES AND LOCATIONS PRIOR TO CONSTRUCTION. IT IS THE RESPONSIBILITY OF THE CONTRACTOR TO REMOVE ALL TREES THAT CONFLICT WITH THE PROPOSED IMPROVEMENTS WHETHER OR NOT THE TREES WERE IDENTIFIED ON THE PLANS.

AREA OF DISTURBANCE

40,570 S.F. (±0.93 AC)

Revision	Date	Description	Detailed By	Chk'd By	Approved By

UTILITY NOTE:

ALL UTILITIES SHOWN ON THESE PLANS ARE APPROXIMATE. INDIVIDUAL SERVICE LINES ARE NOT SHOWN. PRIOR TO ANY EXCAVATION, IT SHALL BE THE RESPONSIBILITY OF THE CONTRACTOR TO CONTACT THE NECESSARY UTILITY AGENCIES AND OBTAIN THE PRECISE LOCATION OF THEIR FACILITIES. THE CONTRACTOR SHALL FAMILIARIZE THEMSELVES WITH ALL UTILITY REQUIREMENTS AS SET OUT ON THE PLANS, IN THE SPECIFICATIONS, AND IN THE SPECIAL PROVISIONS.

THE CONTRACTOR OR SUBCONTRACTOR SHALL NOTIFY THE UTILITY PROTECTION CENTER "HOLEY MOLEY" (TOLL FREE PHONE NO. 1-800-382-5544) TWO (2) WORKING DAYS IN ADVANCE OF ANY CONSTRUCTION ON THIS PROJECT. THIS NUMBER WAS ESTABLISHED TO PROVIDE ACCURATE LOCATIONS OF EXISTING BELOW GROUND UTILITIES (I.E. CABLES, ELECTRIC WIRES, GAS & WATER LINES).



TEMPORARY BENCHMARKS

TBM#1 DESCRIPTION: MAG TAG AT END OF PARKING STRIPE ELEVATION: 871.14

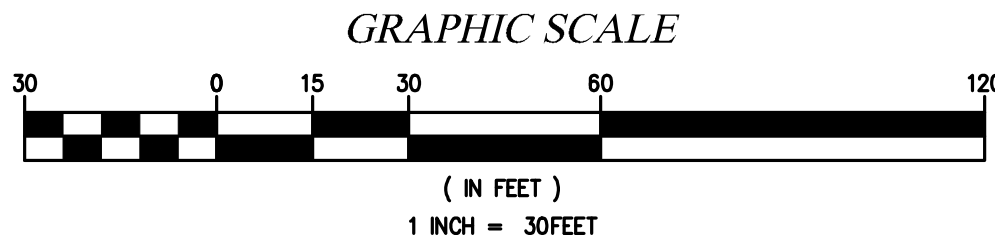

ENGINEER:
HERITAGE ENGINEERING, LLC
642 South 4th Street
Louisville, KY 40202
(502) 582-1412
(502) 582-1413 Fax

OWNER/DEVELOPER:
TOWN OF DILLSBORO
13080 EXECUTIVE DRIVE
P.O. BOX 127
DILLSBORO, IN 47018
(812) 432-3243

PROJECT:
CONSTRUCTION PLANS
FOR
DILLSBORO PARK BASKETBALL & PICKLEBALL COURTS
9495 ARLINGTON ROAD
DILLSBORO, IN
DEMO

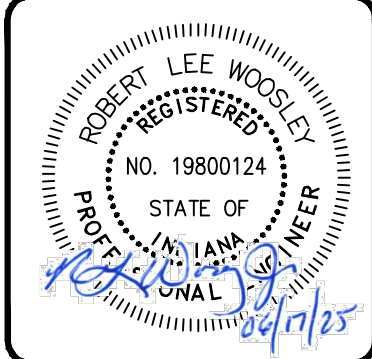

JOB NO:	25017
HORIZ. SCALE:	1"=30'
VERTICAL SCALE:	N/A
DESIGNED BY:	CGH
DETAILED BY:	ELM
CHECKED BY:	-
DATE:	6/17/25

SHEET
C1.0

X:\AA-Projects-2025\25017 - Dillsboro Park Conceptual Plan & Pickleball Courts Design\Construction\25017 - SITE.dwg PLOT DATE: June 20, 2025 - 4:15pm

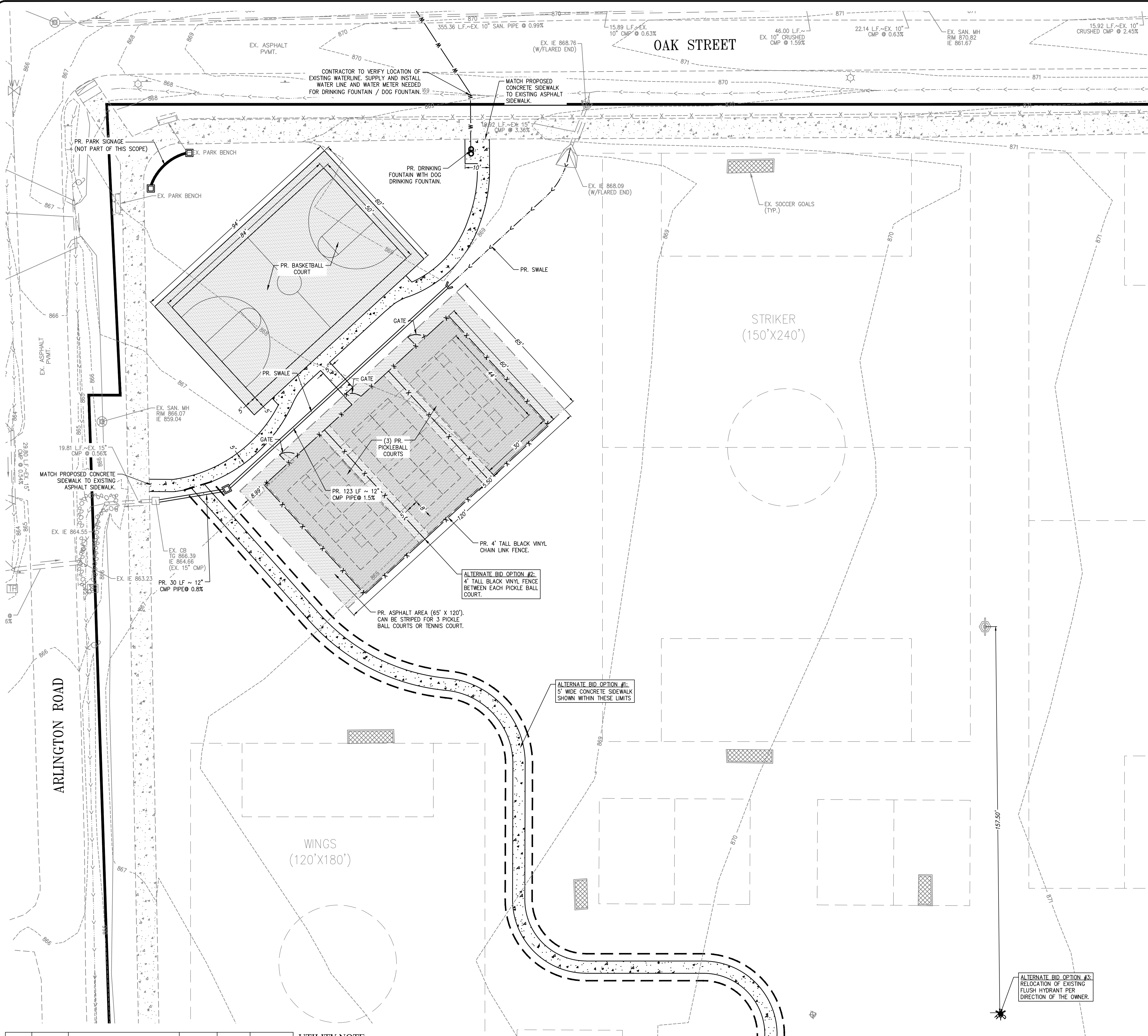

Revision	Date	Description	Detailed By	Chk'd By	Approved By

UTILITY NOTE:
ALL UTILITIES SHOWN ON THESE PLANS ARE APPROXIMATE. INDIVIDUAL SERVICE LINES ARE NOT SHOWN. PRIOR TO ANY EXCAVATION, IT SHALL BE THE RESPONSIBILITY OF THE CONTRACTOR TO CONTACT THE NECESSARY UTILITY AGENCIES AND OBTAIN THE PRECISE LOCATION OF THEIR FACILITIES. THE CONTRACTOR SHALL FAMILIARIZE THEMSELVES WITH ALL UTILITY REQUIREMENTS AS SET OUT ON THE PLANS, IN THE SPECIFICATIONS, AND IN THE SPECIAL PROVISIONS.

THE CONTRACTOR OR SUBCONTRACTOR SHALL NOTIFY THE UTILITY PROTECTION CENTER "HOLEY MOLEY" (TOLL FREE PHONE NO. 1-800-382-5544) TWO (2) WORKING DAYS IN ADVANCE OF ANY CONSTRUCTION ON THIS PROJECT. THIS NUMBER WAS ESTABLISHED TO PROVIDE ACCURATE LOCATIONS OF EXISTING BELOW GROUND UTILITIES (I.E. CABLES, ELECTRIC WIRES, GAS & WATER LINES).



TEMPORARY BENCHMARKS
TBM#1 DESCRIPTION: MAG TAG AT END OF PARKING STRIPE ELEVATION: 871.14

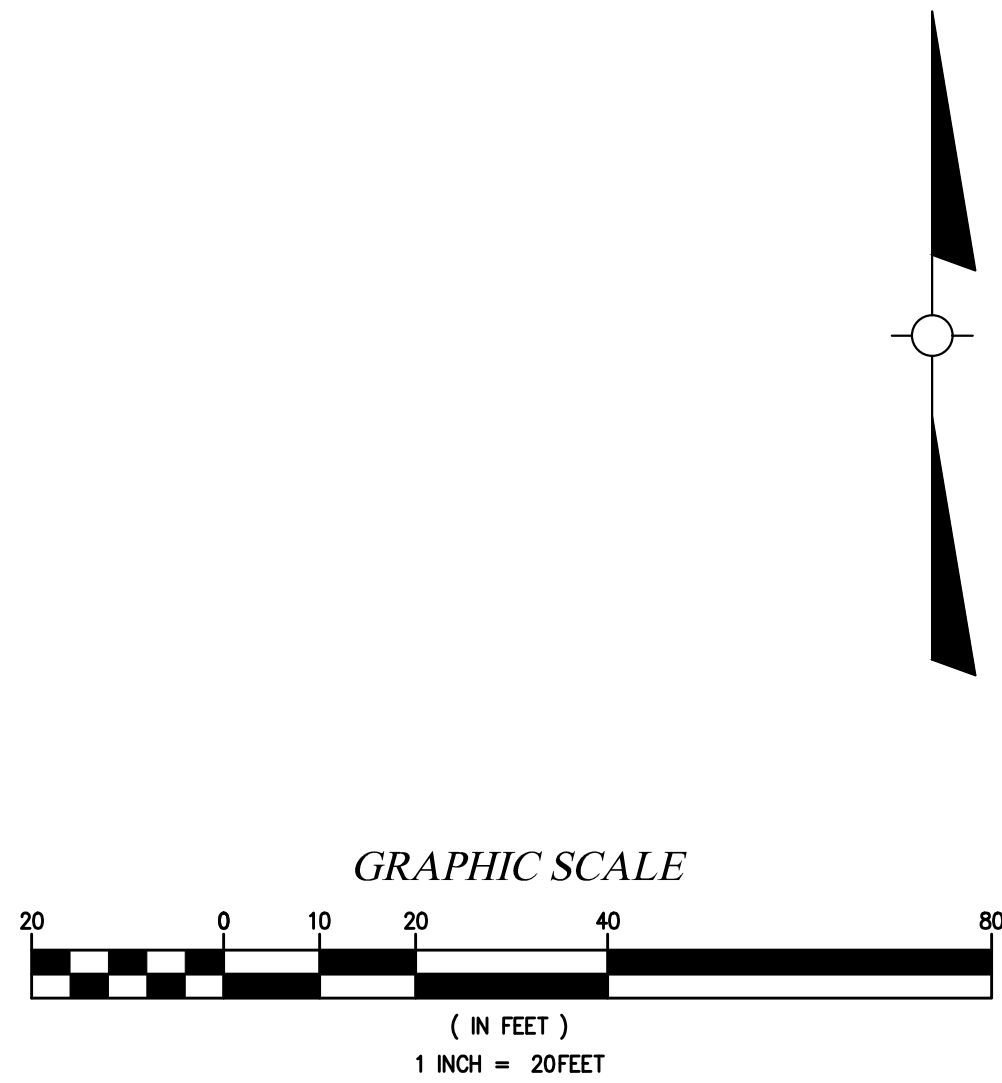
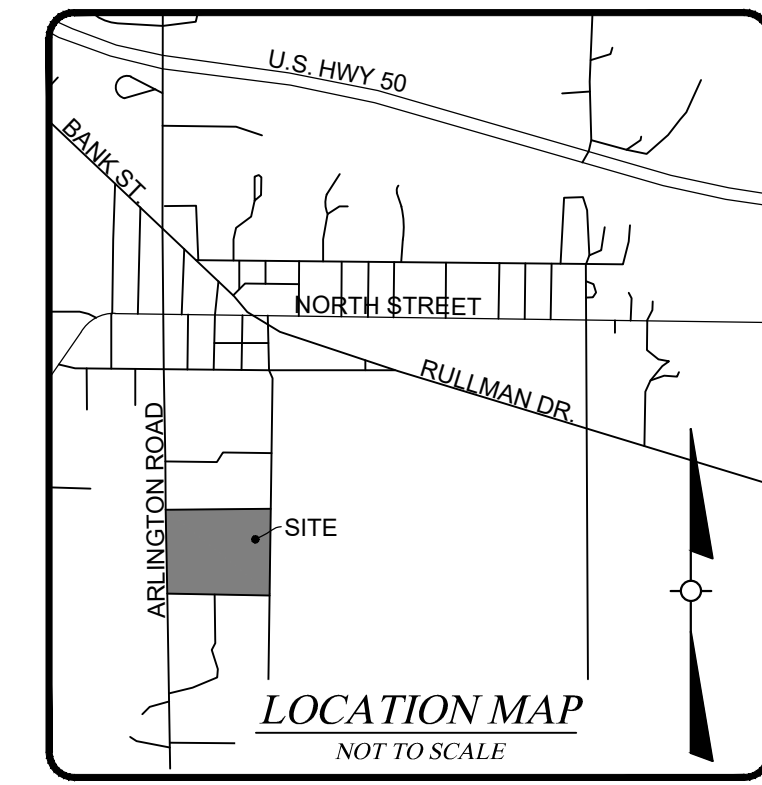

ENGINEER:

HERITAGE ENGINEERING, LLC

642 South 4th Street
Suite 100
Louisville, KY 40202
(502) 582-1412
(502) 582-1413 Fax

OWNER/DEVELOPER:

TOWN OF DILLSBORO
13080 EXECUTIVE DRIVE
P.O. BOX 127
DILLSBORO, IN 47018
(812) 432-3243

PROJECT:

**CONSTRUCTION PLANS FOR
DILLSBORO PARK BASKETBALL &
PICKLEBALL COURTS**
9495 ARLINGTON ROAD
DILLSBORO, IN
SITE LAYOUT

PROF. SEAL

ROBERT LEE WOOLEY
REGISTERED
NO. 19800124
STATE OF INDIANA
PEL
6/21/25

JOB NO: 25017
HORIZ. SCALE: 1"=20'
VERTICAL SCALE: N/A
DESIGNED BY: CGH
DETAILED BY: ELM
CHECKED BY: -
DATE: 6/20/25

SHEET

C2.0

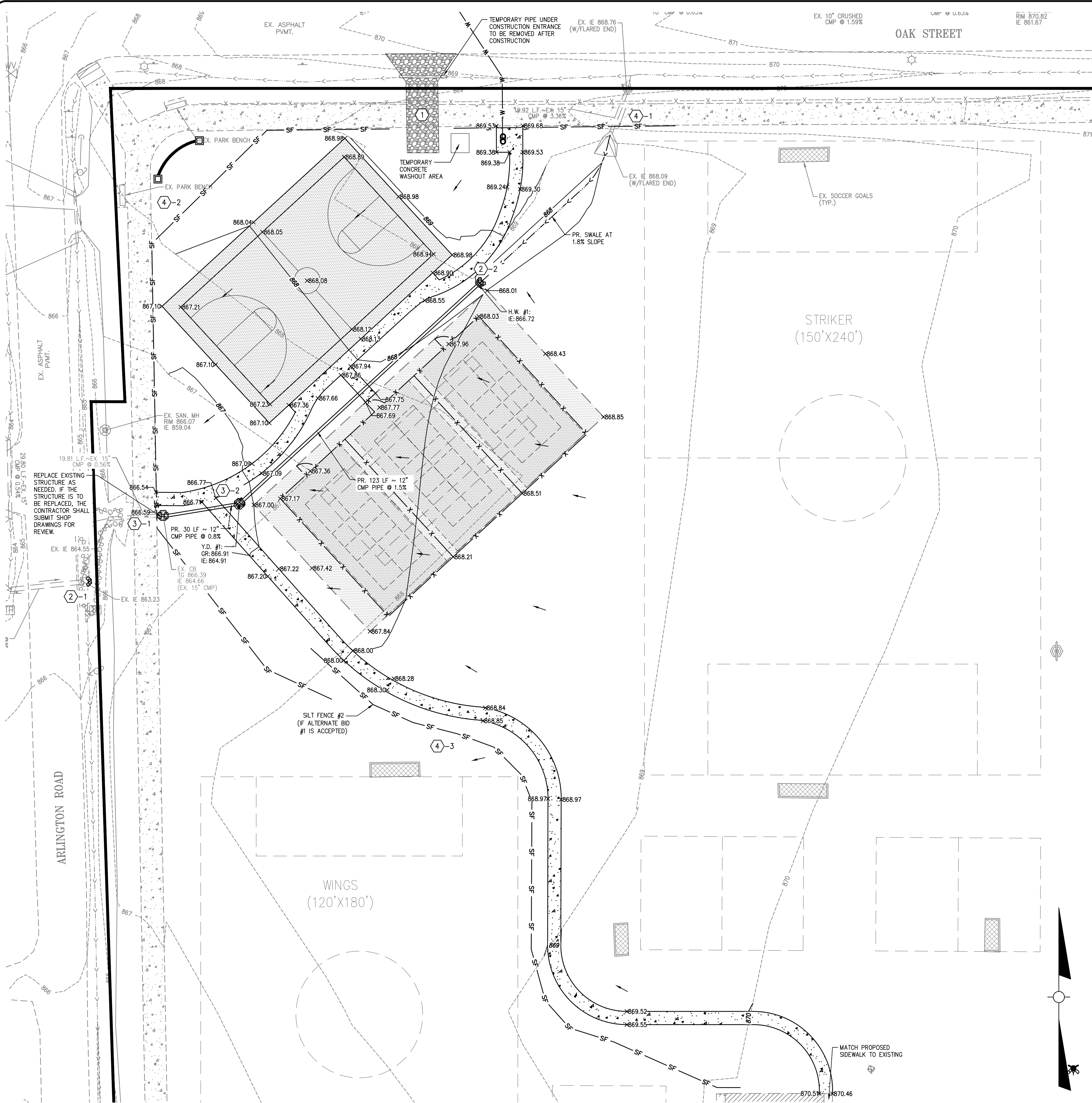

GRADING NOTES

- NO TREES ARE TO BE REMOVED AND/OR VEGETATION DISTURBED EXCEPT AS NECESSARY FOR GRADING PURPOSES AND ONLY AS APPROVED BY THE OWNER'S REPRESENTATIVE.
- TOPSOIL IS TO BE STRIPPED FROM ALL CUT AND FILL AREAS, STOCKPILED AND REDISTRIBUTED OVER GRADED AREAS TO A MINIMUM DEPTH OF 6".
- ALL VEGETATED AREAS INCLUDING SLOPES ARE TO BE MULCHED AND SEEDED AS SOON AS POSSIBLE AFTER GRADING IS COMPLETED. CONSTRUCT SILT BARRIERS AS SHOWN ON DRAWINGS PRIOR TO BEGINNING GRADING OPERATIONS.
- ALL NEW STRUCTURES AND EXISTING STRUCTURES SHALL HAVE SEDIMENT REMOVED PRIOR TO FINAL ACCEPTANCE.
- ALL DIMENSIONS AND LOCATIONS OF TEMPORARY EROSION AND WATER POLLUTION CONTROL DEVICES SHALL BE SUBJECT TO ADJUSTMENT AS DESIGNATED BY THE OWNER'S REPRESENTATIVE.
- REPLACE SILT BARRIERS AS DIRECTED BY THE OWNER'S REPRESENTATIVE.
- THE CONTRACTOR IS TO VERIFY THE EXACT LOCATION OF ALL EXISTING UTILITIES. TAKE CARE TO PROTECT UTILITIES THAT ARE TO REMAIN. REPAIR ANY DAMAGE ACCORDING TO LOCAL STANDARDS AND AT THE CONTRACTOR'S EXPENSE. COORDINATE ALL CONSTRUCTION WITH THE APPROPRIATE UTILITY COMPANY.
- THE CONTRACTOR IS TO CHECK ALL FINISHED GRADES, EXISTING GRADES AND DIMENSIONS IN THE FIELD AND REPORT ANY DISCREPANCIES TO THE OWNER'S REPRESENTATIVE.
- THE CONTRACTOR SHALL CONFORM TO ALL LOCAL CODES AND RECEIVE APPROVAL WHERE NECESSARY BEFORE CONSTRUCTION.
- PROVIDE 2% MAX SLOPE ON PAVEMENT IN ALL DIRECTIONS IN ACCESSIBLE PARKING SPACES & ADJACENT SAFE ZONE.
- MAX LONGITUDINAL SLOPE ON ALL SIDEWALKS IS 5% MAX. CROSS SLOPE IS 2%.
- MAX CROSS SLOPE ON CROSS WALKS IS 2%.

EROSION CONTROL LEGEND		
1		TEMPORARY CONSTRUCTION ENTRANCE WITH CULVER PIPE
2		WINGED HEADWALL INLET PROTECTION
3		STONE BAG INLET PROTECTION
4		SILT FENCE

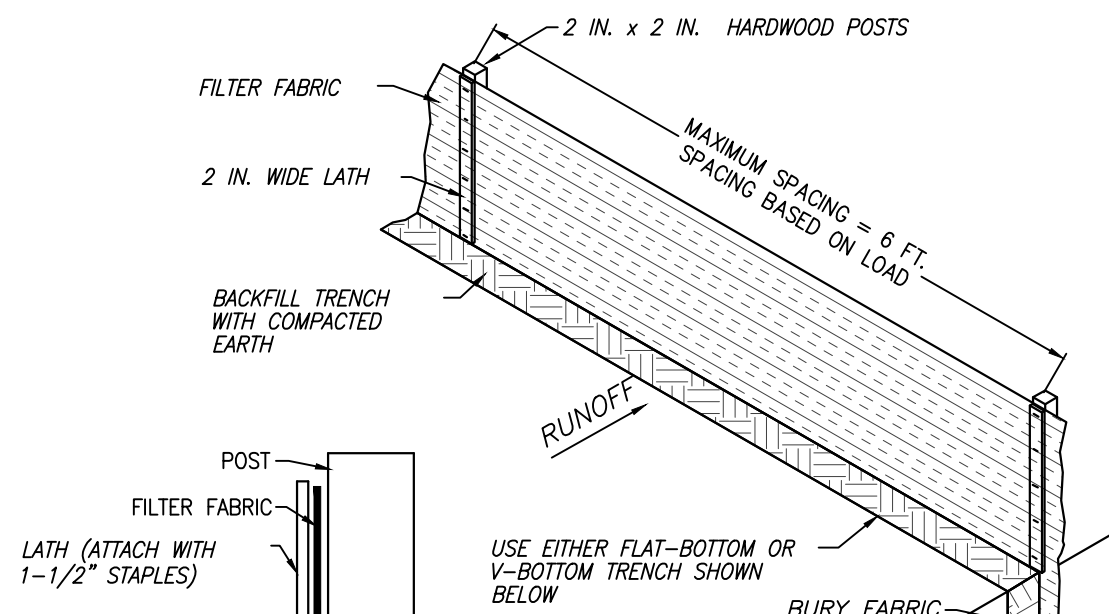

FABRIC ATTACHMENT DETAIL

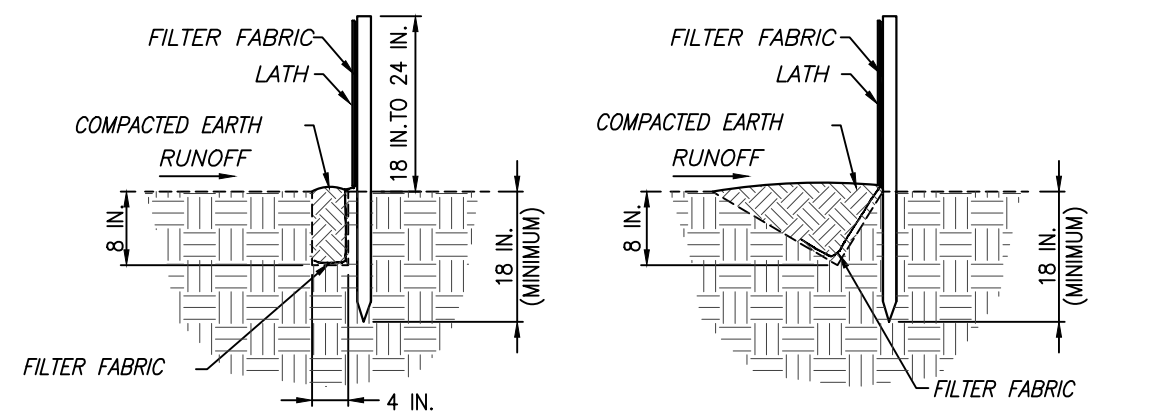

FLAT-BOTTOM TRENCH SECTION

V-SHAPED TRENCH SECTION

SILT FENCE N.T.S.

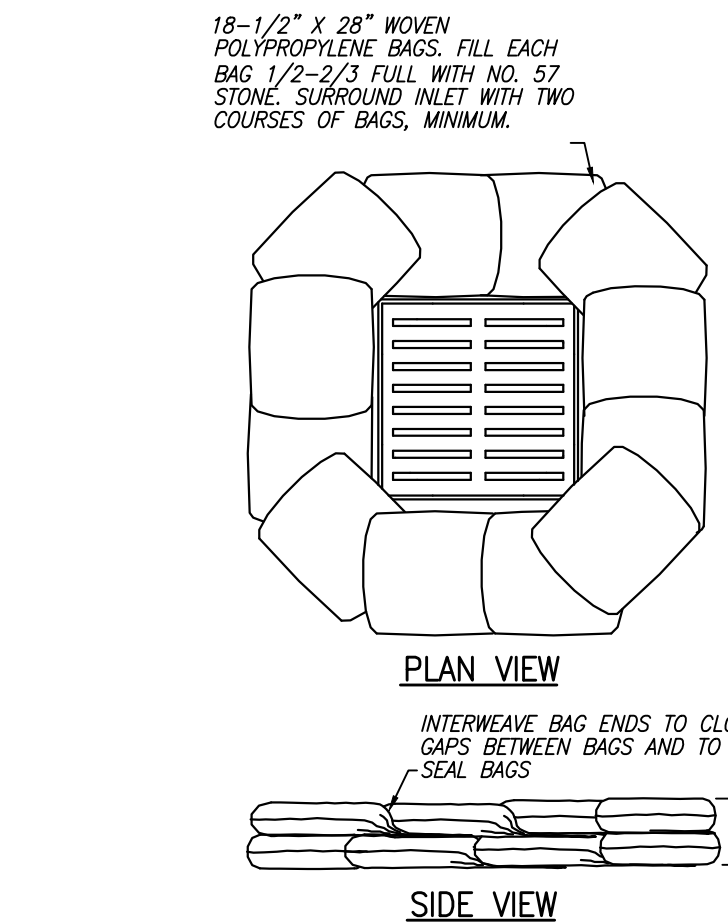

- NOTES:
- THE 12-INCH HEIGHT REQUIREMENT IS WAIVED IN CASES WHERE IT WILL CAUSE FLOOD DAMAGE IF THE STONE BAGS ARE OVERTOPPED.
 - STONE BAG INLET PROTECTION IS SUITABLE FOR USE IN BOTH PAVED AND UNPAVED AREAS.
 - MAXIMUM CONTRIBUTING DRAINAGE AREA = 1 ACRE.

STONE BAG INLET PROTECTION N.T.S.

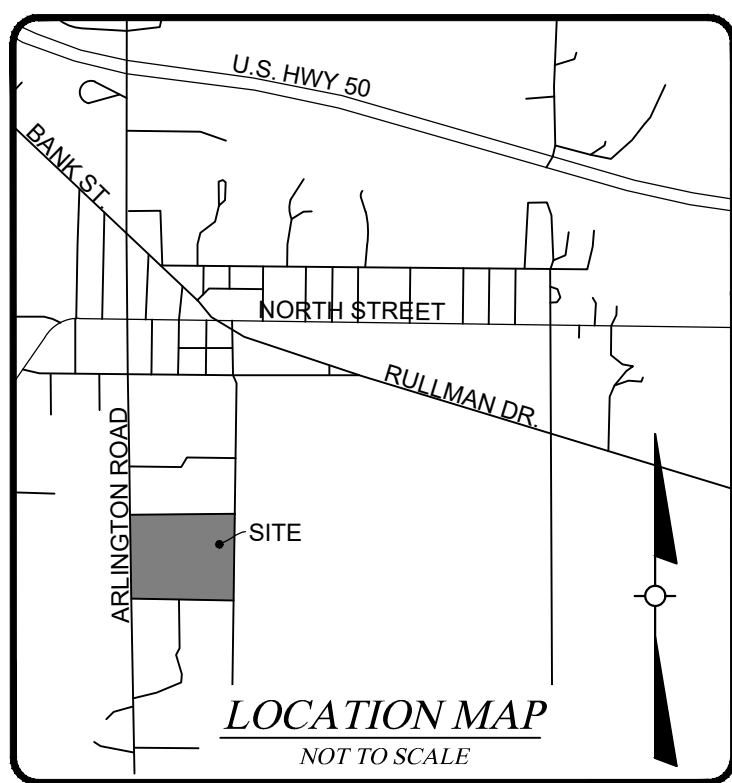

LOCATION MAP NOT TO SCALE

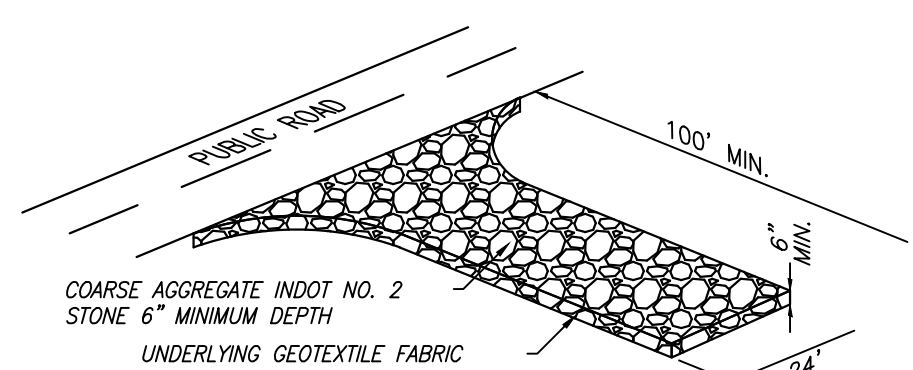

- NOTES:
- INSTALL A CULVERT PIPE ACROSS THE ENTRANCE WHEN NEEDED TO PROVIDE POSITIVE DRAINAGE.
 - DIVERT ALL SURFACE RUNOFF AND DRAINAGE FROM THE STONE PAD TO A SEDIMENT TRAP OR BASIN OR OTHER SEDIMENT TRAPPING STRUCTURE.

TEMPORARY CONSTRUCTION ENTRANCE N.T.S.

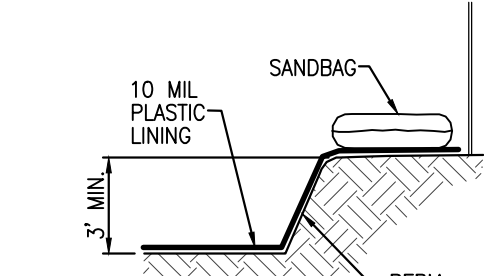

SECTION A-A

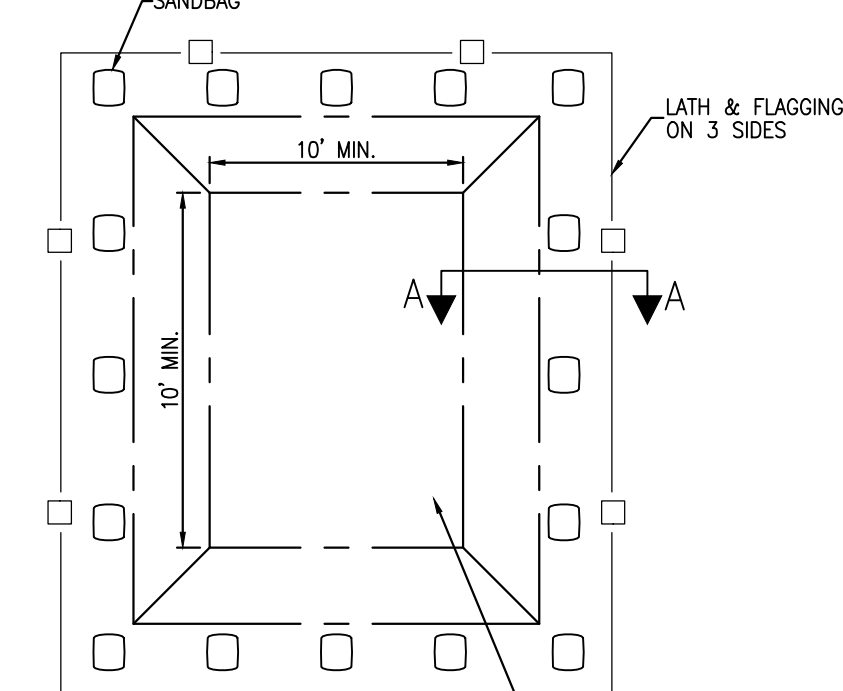

PLAN

CONCRETE WASHOUT AREA N.T.S.

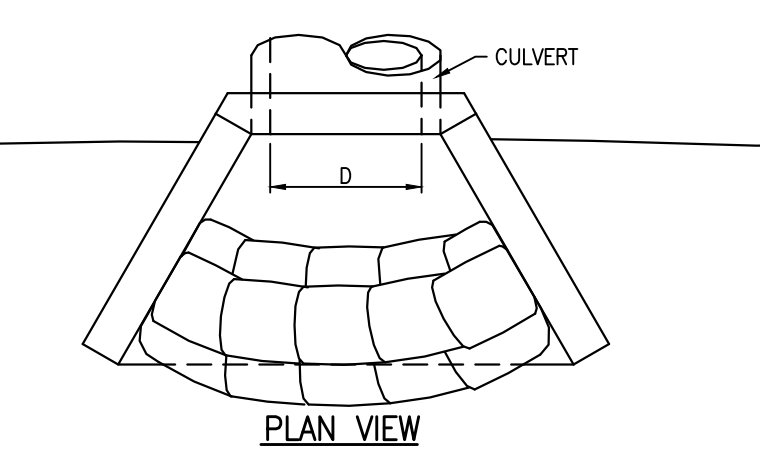

PLAN VIEW

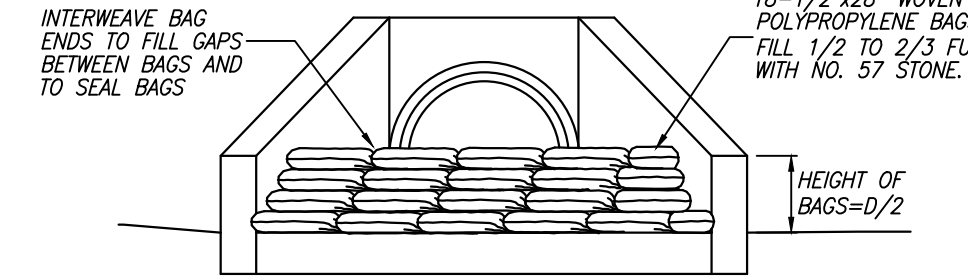

UPSTREAM ELEVATION

HEADWALL INLET PROTECTION NOT TO SCALE

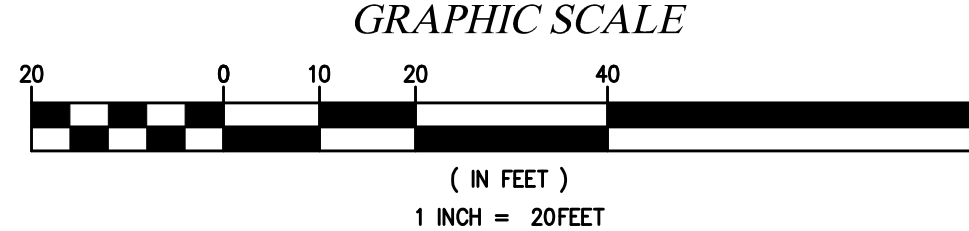

Revision	Date	Description	Detailed By	Chk'd By	Approved By

UTILITY NOTE:

ALL UTILITIES SHOWN ON THESE PLANS ARE APPROXIMATE. INDIVIDUAL SERVICE LINES ARE NOT SHOWN. PRIOR TO ANY EXCAVATION, IT SHALL BE THE RESPONSIBILITY OF THE CONTRACTOR TO CONTACT THE NECESSARY UTILITY AGENCIES AND OBTAIN THE PRECISE LOCATION OF THEIR FACILITIES. THE CONTRACTOR SHALL FAMILIARIZE THEMSELVES WITH ALL UTILITY REQUIREMENTS AS SET OUT ON THE PLANS, IN THE SPECIFICATIONS, AND IN THE SPECIAL PROVISIONS.

THE CONTRACTOR OR SUBCONTRACTOR SHALL NOTIFY THE UTILITY PROTECTION CENTER "HOLEY MOLEY" (TOLL FREE PHONE NO. 1-800-382-5544) TWO (2) WORKING DAYS IN ADVANCE OF ANY CONSTRUCTION ON THIS PROJECT. THIS NUMBER WAS ESTABLISHED TO PROVIDE ACCURATE LOCATIONS OF EXISTING BELOW GROUND UTILITIES (I.E. CABLES, ELECTRIC WIRES, GAS & WATER LINES).



TEMPORARY BENCHMARKS

DESCRIPTION: MAG TAG AT END OF PARKING STRIPE ELEVATION: 871.14

ENGINEER: **HERITAGE ENGINEERING, LLC**
603 North State Drive
Suite 100
Louisville, KY 40202
(502) 562-1412
(502) 562-1413 Fax

OWNER/DEVELOPER: **TOWN OF DILLSBORO**
13080 EXECUTIVE DRIVE
P.O. BOX 127
DILLSBORO, IN 47018
(812) 432-3243

PROJECT: **CONSTRUCTION PLANS FOR DILLSBORO PARK BASKETBALL & PICKLEBALL COURTS**
9495 ARLINGTON ROAD
DILLSBORO, IN 47018
GRADING

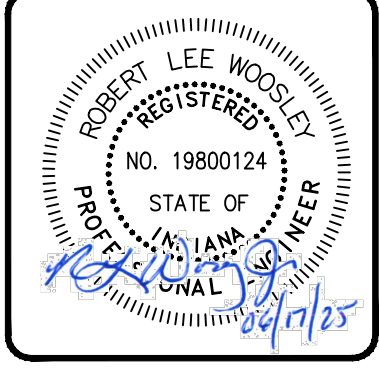

JOB NO:	25017
HORIZ. SCALE:	1"=20'
VERTICAL SCALE:	N/A
DESIGNED BY:	CGH
DETAILED BY:	ELM
CHECKED BY:	-
DATE:	6/20/25

SHEET **C3.0**

X:\AA-Projects-2025\25017 - Dillsboro Park Conceptual Plan & Pickleball Courts Design\Construction\25017 - DETAILS.dwg PLOT DATE: June 20, 2025 - 4:28pm

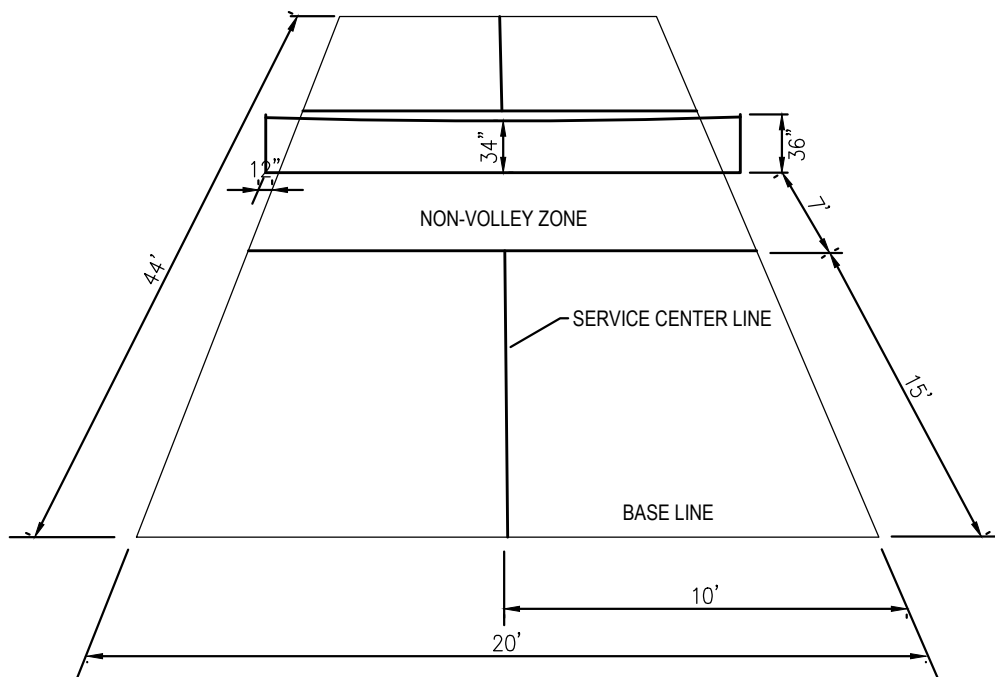

PICKLEBALL COURT PLAYING
LINE LAYOUT
N.T.S.

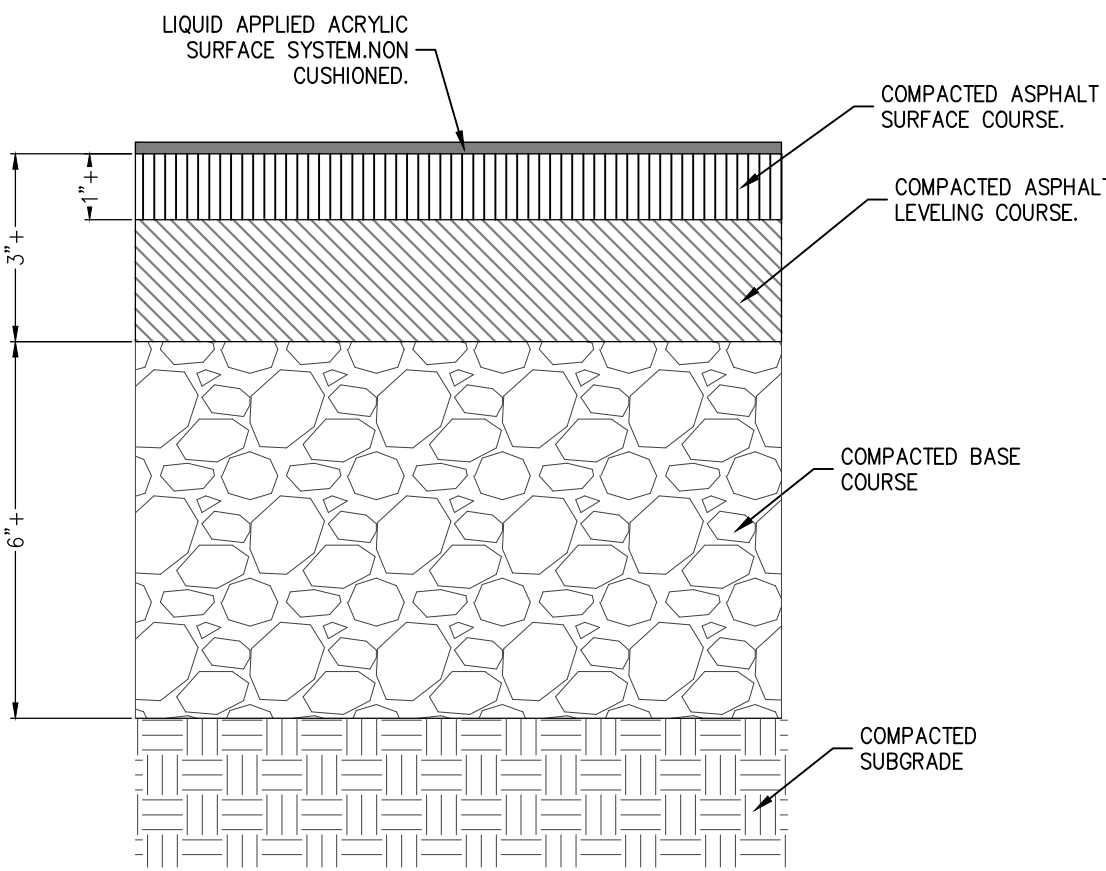

PICKLEBALL / TENNIS COURT SURFACE
(ASPHALT)
N.T.S.

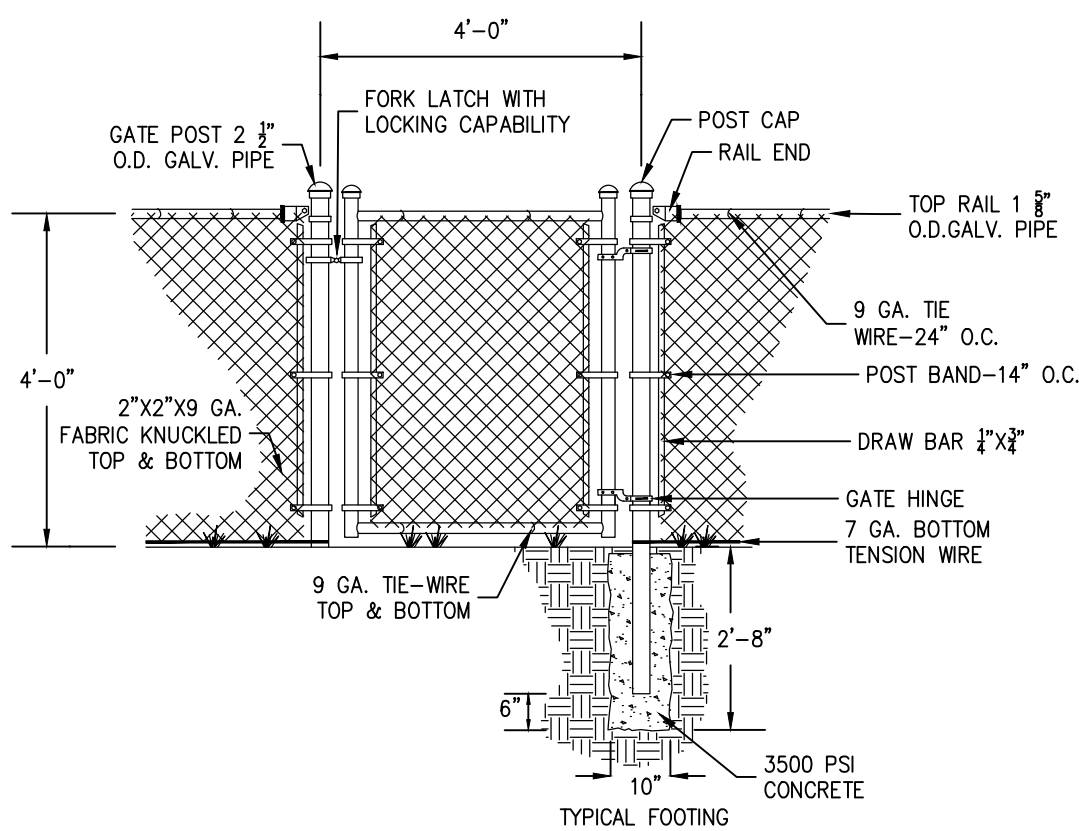

4 FT TALL CHAIN LINK FENCE GATE
N.T.S.

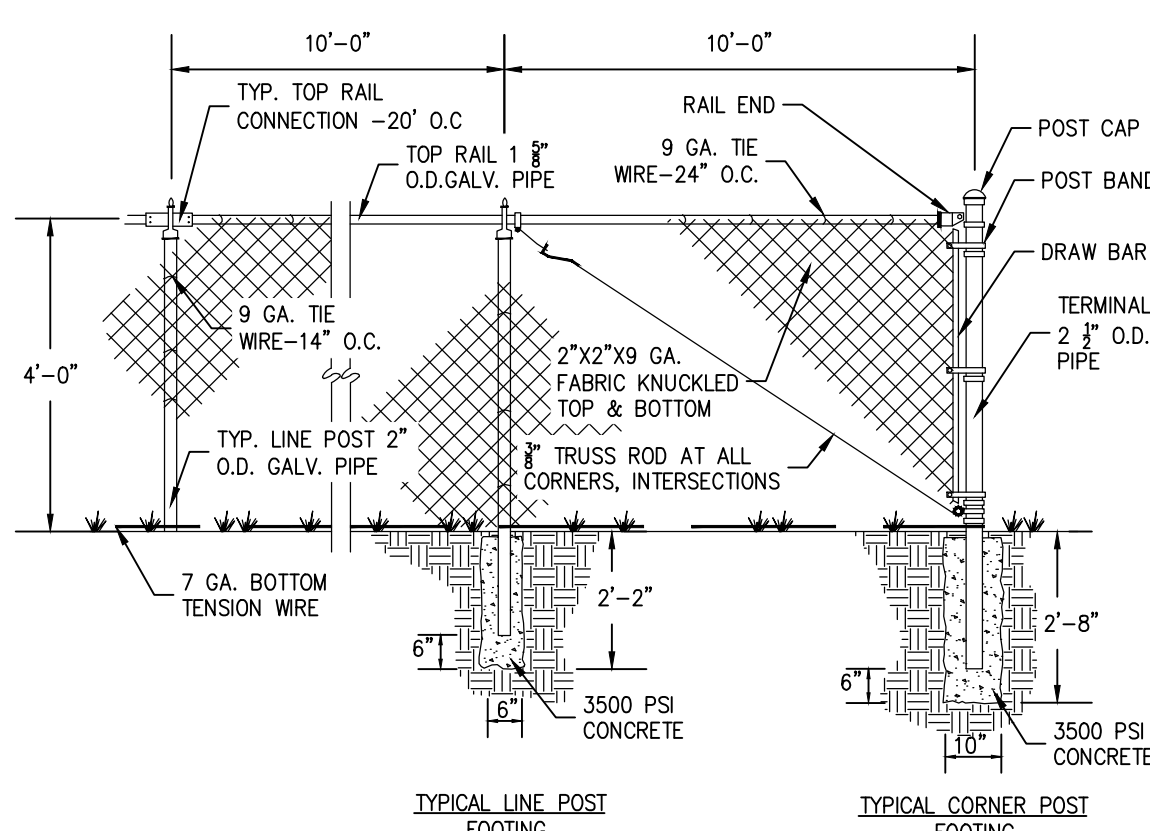

4 FT TALL CHAIN LINK FENCE
N.T.S.

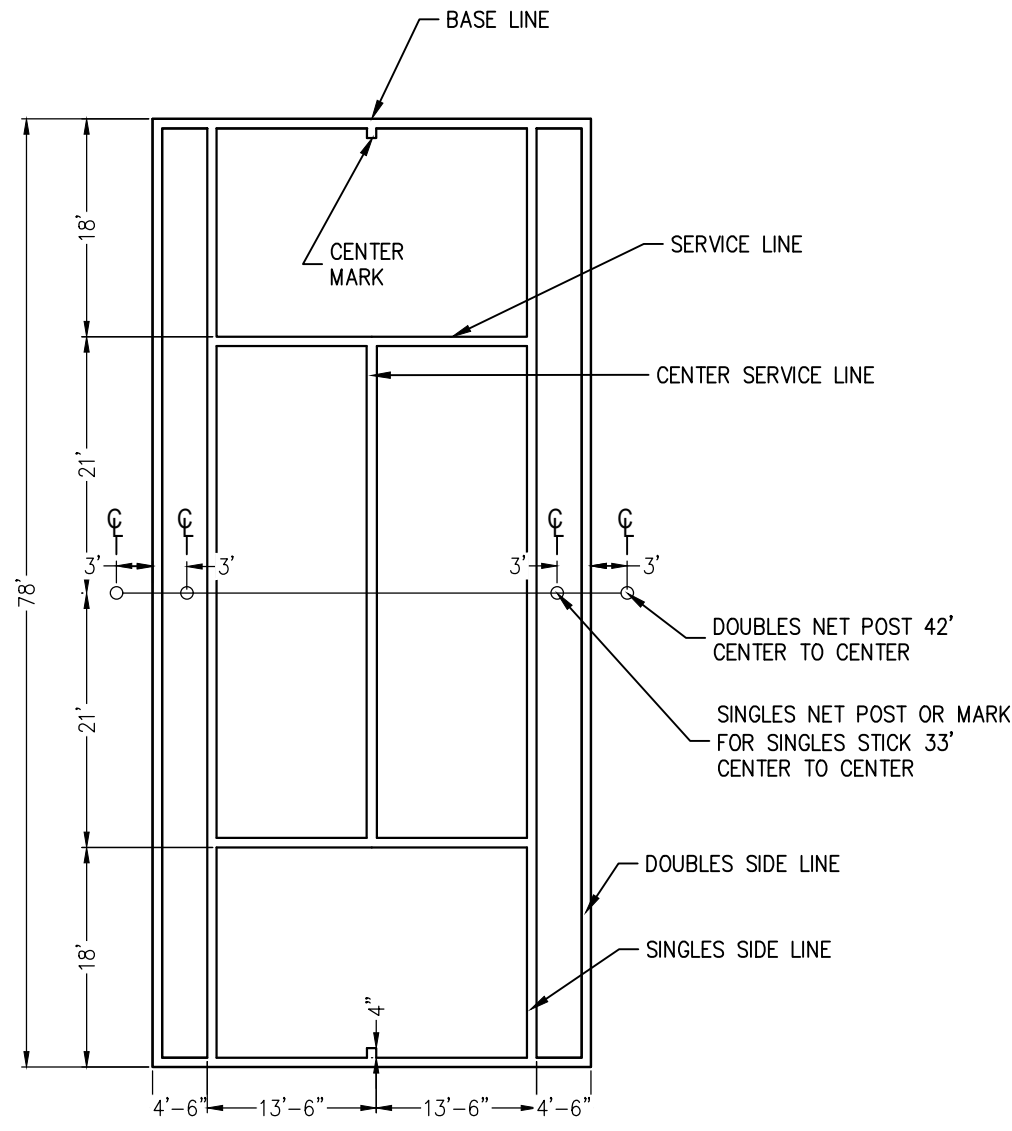

TENNIS COURT PLAYING LINE
LAYOUT
N.T.S.

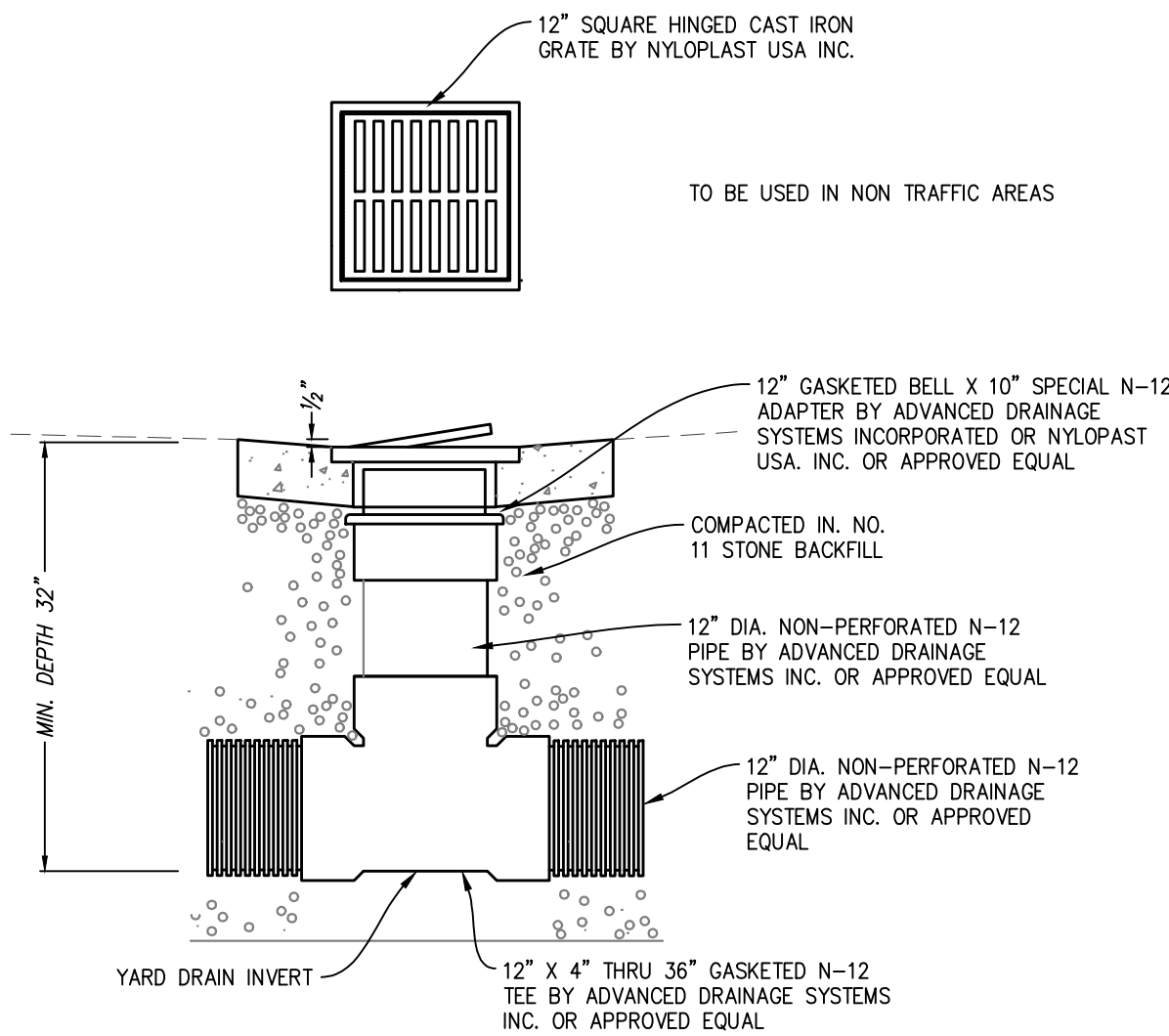

12' X 12' YARD DRAIN

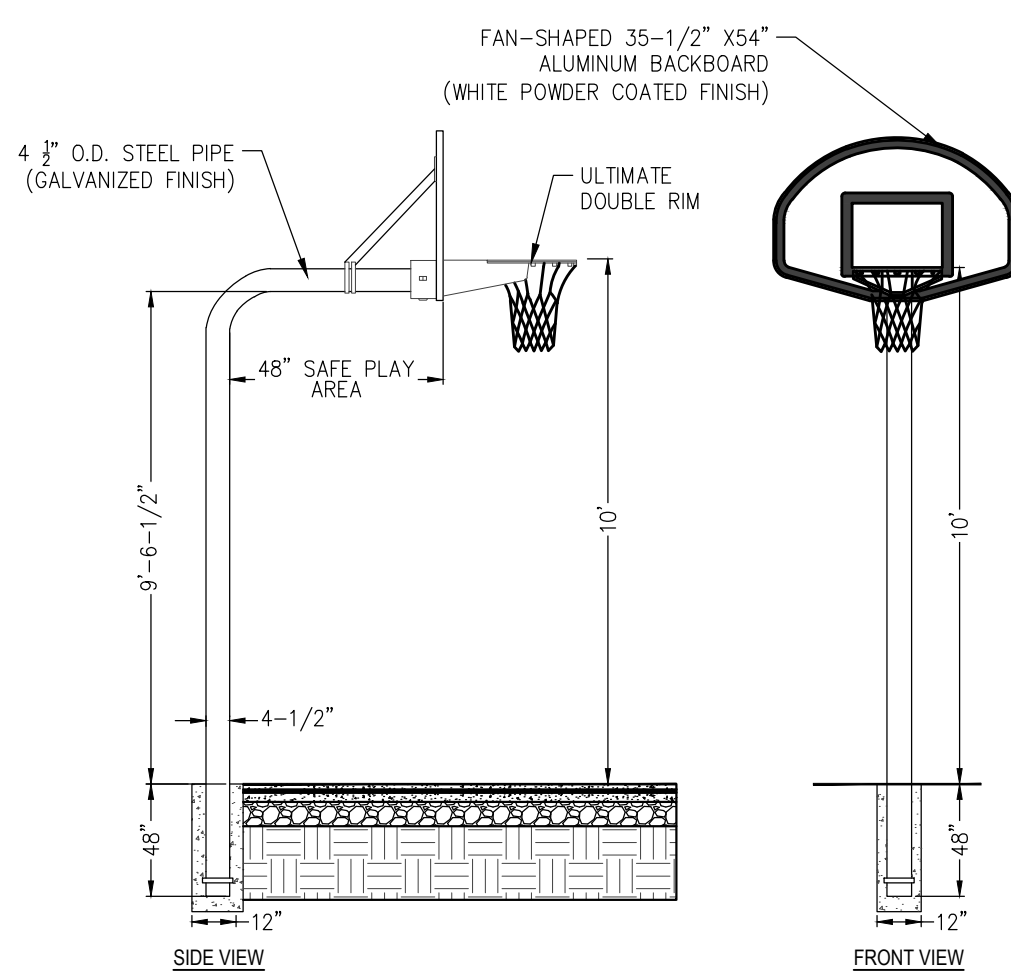

- NOTES:
- GOAL SYSTEM SHALL BE A "PR52 HEAVY-DUTY PACKAGE" BY IPI BY BISON (OR APPROVED EQUIVALENT).
 - INSTALLATION TO BE COMPLETED IN ACCORDANCE WITH MANUFACTURER'S SPECIFICATIONS.
 - PRIOR TO INSTALLATION, CONTRACTOR SHALL VERIFY BRAND OF GOAL WITH CLIENT.

TYPICAL BASKETBALL GOAL
N.T.S.

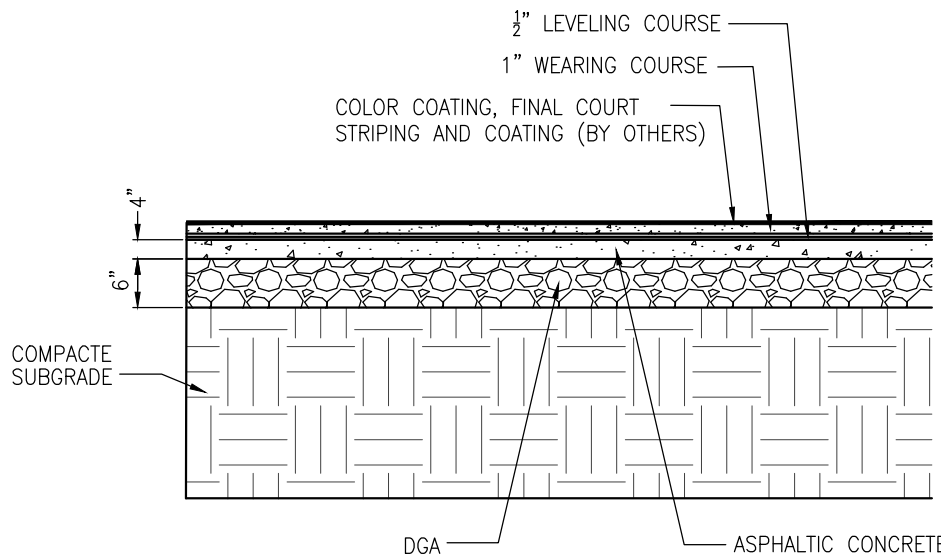

BASKETBALL COURT SURFACE
N.T.S.



MOST DEPENDABLE FOUNTAINS, INC.
5705 COMMANDER DR. P.O. BOX 587
ARLINGTON, TN 38002-0587
PHONE: (901) 867-0039
FAX: (901) 867-0159
www.mostdependable.com

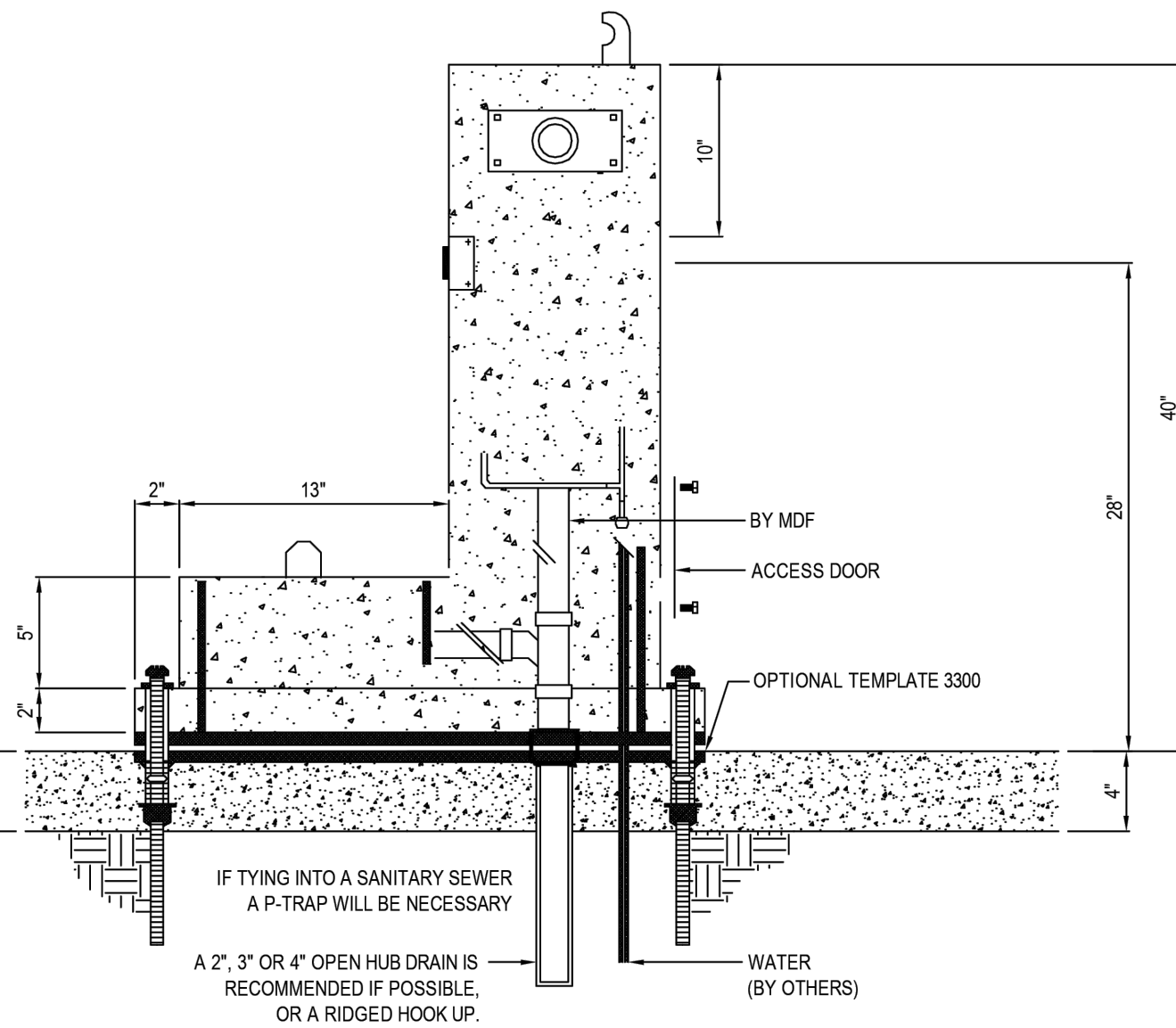

DRINKING FOUNTAIN WITH DOG DRINKING FOUNTAIN
(OR APPROVED EQUAL)
N.T.S.

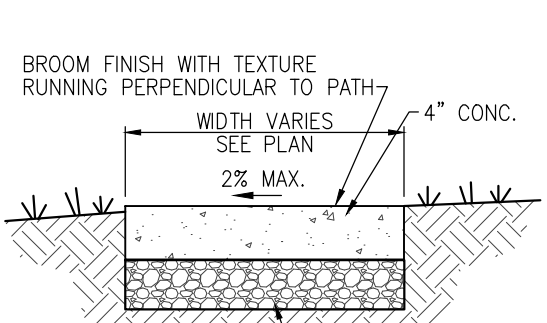

- NOTES:
- CONSTRUCT 1" DEEP CONTROL JOINTS, 4' O.C.
 - JOINTS MAY BE FORMED WITH 1/4" RADIUS JOINTER.
 - EXPANSION JOINTS @ 30' O.C. MAX.
 - CONCRETE SHALL BE 6" AT DRIVEWAYS.

SIDEWALK SECTION
N.T.S.

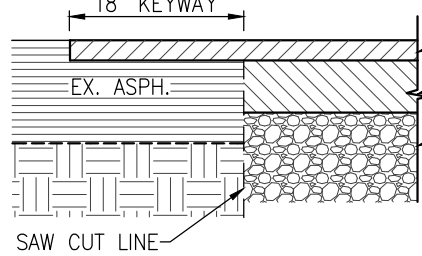

- NOTES:
- CONTRACTOR TO SAWCUT EXISTING PAVEMENT AT LIMITS OF CONSTRUCTION EDGE TO PROVIDE VERTICAL EDGE IN AREAS OF PROPOSED PAVEMENT.
 - PROPOSED PAVEMENT TO MATCH EXISTING PAVEMENT FLUSH AND EXTEND EXISTING CROSS SLOPE TO PROPOSED EDGE OF SHOULDER.
 - MILL EX. SURFACE 2" TO PROVIDE KEYWAY FOR NEW ASPHALT SURFACE. WIDTH OF MILLING SHOULD BE 18".

SAW CUT PAVEMENT
N.T.S.

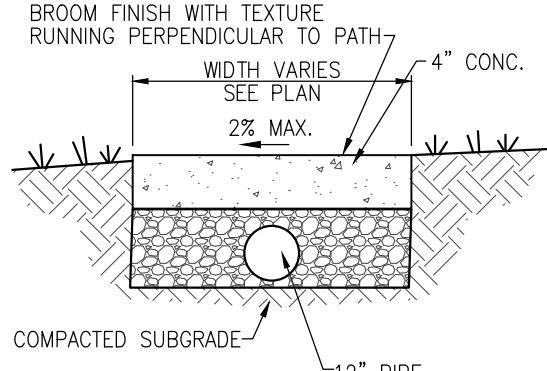

PIPE UNDER SIDEWALK
SECTION
N.T.S.

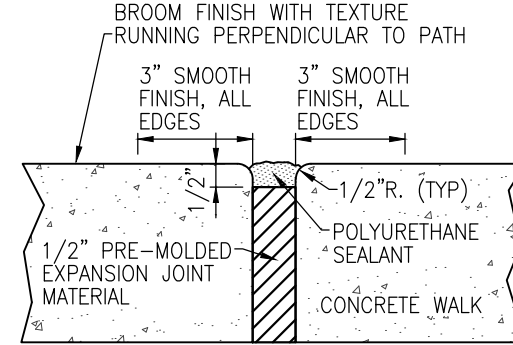

EXPANSION JOINT
N.T.S.

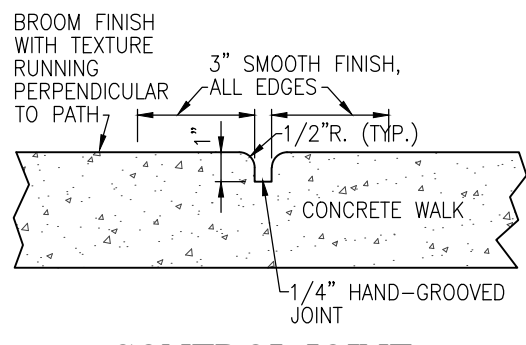

CONTROL JOINT
N.T.S.

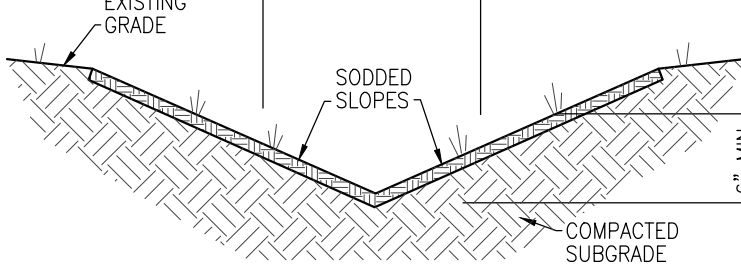

EARTH 'V' DITCH DETAIL
N.T.S.

UTILITY NOTE:

ALL UTILITIES SHOWN ON THESE PLANS ARE APPROXIMATE. INDIVIDUAL SERVICE LINES ARE NOT SHOWN. PRIOR TO ANY EXCAVATION, IT SHALL BE THE RESPONSIBILITY OF THE CONTRACTOR TO CONTACT THE NECESSARY UTILITY AGENCIES AND OBTAIN THE PRECISE LOCATION OF THEIR FACILITIES. THE CONTRACTOR SHALL FAMILIARIZE THEMSELVES WITH ALL UTILITY REQUIREMENTS AS SET OUT ON THE PLANS, IN THE SPECIFICATIONS, AND IN THE SPECIAL PROVISIONS.

THE CONTRACTOR OR SUBCONTRACTOR SHALL NOTIFY THE UTILITY PROTECTION CENTER "HOLEY MOLEY" (TOLL FREE PHONE NO. 1-800-382-5544) TWO (2) WORKING DAYS IN ADVANCE OF ANY CONSTRUCTION ON THIS PROJECT. THIS NUMBER WAS ESTABLISHED TO PROVIDE ACCURATE LOCATIONS OF EXISTING BELOW GROUND UTILITIES (I.E. CABLES, ELECTRIC WIRES, GAS & WATER LINES).



Revision	Date	Description	Detailed By	Chk'd By	Approved By

ENGINEER:

HERITAGE ENGINEERING, LLC

603 North Shore Drive
Suite 204
Jeffersville, IN 47130
(812) 280-8201
(812) 280-0231 Fax

OWNER/DEVELOPER:

TOWN OF DILLSBORO
13080 EXECUTIVE DRIVE
P.O. BOX 127
DILLSBORO, IN 47018
(812) 432-3243

PROJECT:

CONSTRUCTION PLANS
FOR
DILLSBORO PARK BASKETBALL & PICKLEBALL COURTS
9495 ARLINGTON ROAD
DILLSBORO, IN
DETAILS

REGISTERED PROFESSIONAL ENGINEER

ROBERT LEE WOOLEY
NO. 19800124
STATE OF INDIANA
EXPIRATION DATE 12/31/25

JOB NO: 25017
HORIZ. SCALE: N/A
VERTICAL SCALE: N/A
DESIGNED BY: CGH
DETAILED BY: ELM
CHECKED BY: -
DATE: 6/20/25

SHEET

C4.0